



self-priming liquid ring pumps (with anti-seize motor bracket)



CKm 80



PERFORMANCE RANGE

Flow rate up to 50 l/min (3 m³/h)
Dynamic head up to 51 m

OPERATING LIMITS

Suction lift up to 9 m
Fluid temperature up to + 60°C
Maximum ambient temperature + 40°C

CONSTRUCTION AND SAFETY STANDARDS:

EN 60 335-1	EN 60034-1
IEC 335-1	IEC 34-1
CEI 61-150	CEI 2-3

PUMP INSTALLATION AND APPLICATIONS

These pumps are recommended for clean water without abrasive particles and fluids which are not chemically aggressive to the pump components. **THE PARTICULAR OPERATING PRINCIPLE FOR CK PUMPS MAKES THEM SUITABLE FOR ALL APPLICATIONS WHERE AN EXTREMELY COMPACT SELF-PRIMING PUMP IS REQUIRED TO DEAL WITH LOW OR IRREGULAR FLOW RATES. CORRECT OPERATION IS ALSO ENSURED IN PROBLEM CASES:**

- WHEN PUMPING VOLATILE OR FOAMY FLUIDS;
- WHEN HANDLING LIQUIDS MIXED WITH GAS;
- TO ABSOLUTELY GUARANTEE PRIMING OR PROTECT AGAINST DROPOUT.

The pumps should be installed in a covered area, protected against weather.

WARRANTY: 2 YEARS

(according to our general sales conditions).

STRUCTURAL CHARACTERISTICS

- **PUMP BODY:**
cast iron, with UNI ISO 228/1 gas threaded suction and delivery openings.
- **MOTOR BRACKET patented n° 1289150:**
aluminium with brass insert; reducing difficulties when starting the pump after long periods without use, due to the impeller blocking.
- **IMPELLER:**
brass, with open radial blades.
- **MOTOR SHAFT:**
AISI 430F stainless steel (AISI 416 up to 0.37 kW).
- **MECHANICAL SEAL:**
ceramic, graphite and Viton.
- **MOTOR:**
the pumps are coupled to an asynchronous, high efficiency PEDROLLO induction motor of suitable size, which is quiet, closed and externally ventilated, suitable for continuous duty. INSULATION class B.
The thermal cutout relay (motor protector) is incorporated in all single phase motors.
Three phase motors require an adequate external motor protector, with connections according to current standards.
- **PROTECTION:**
IP 44.

SPECIAL FEATURE ON REQUEST

- ⇒ A type of CK 50 is available with bypass that reduces maximum dynamic head to 20 meters.



PERFORMANCE CHART AT n= 2900 1/min

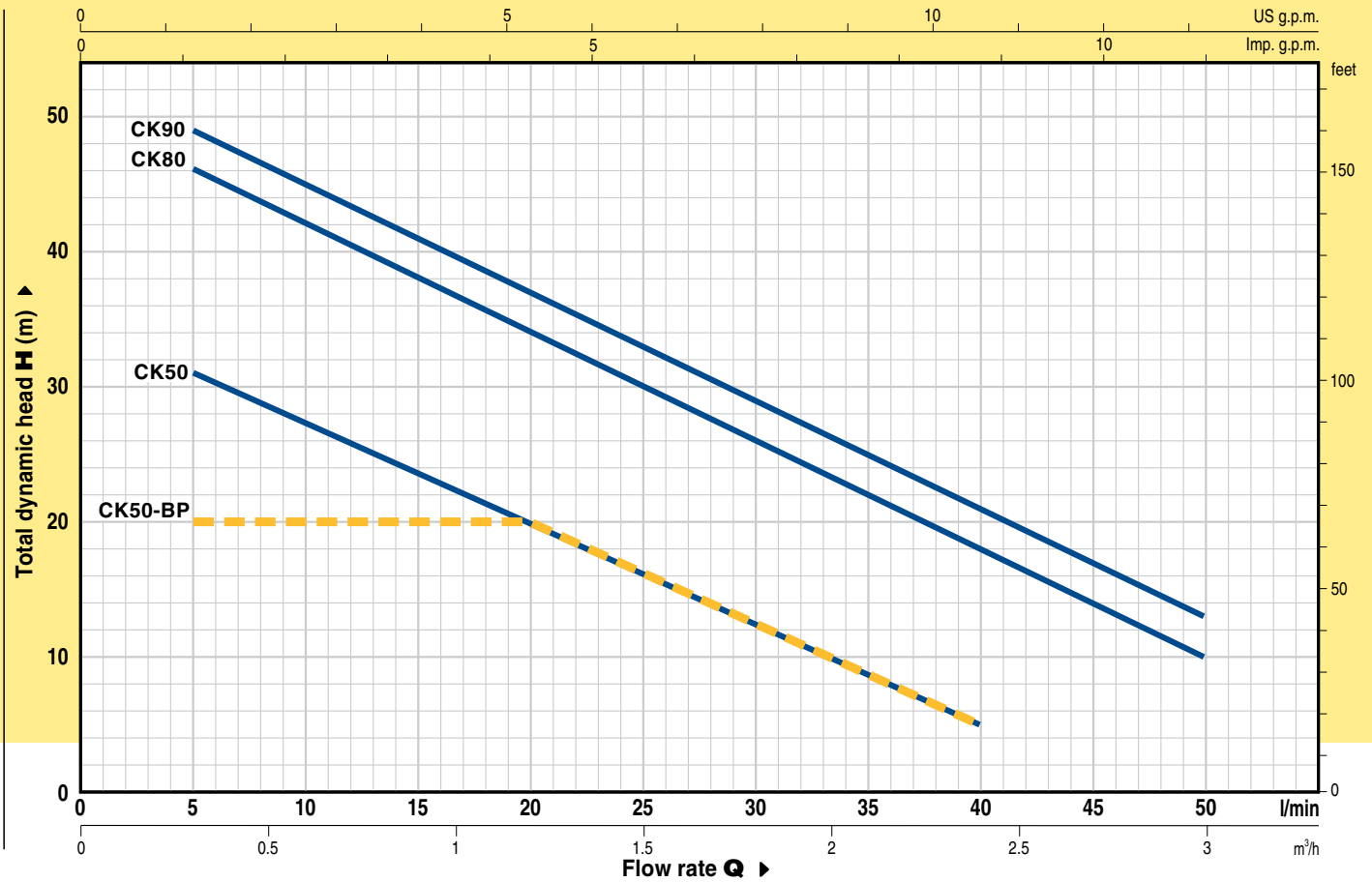

PERFORMANCE DATA AT n= 2900 1/min

PUMP MODEL		POWER		Q	0	0.3	0.6	0.9	1.2	1.5	1.8	2.1	2.4	3.0
Single phase	Three phase	kW	HP	m³/h	0	5	10	15	20	25	30	35	40	50
				l/min	0	5	10	15	20	25	30	35	40	50
CKm 50	CK 50	0.37	0.50	H (m)	35	31	27	24	20	16	13	9	5	
CKm 50-BP	CK 50-BP	0.25	0.33		20	20	20	20	20	16.5	13	9	5	
CKm 80	CK 80	0.60	0.85		48	46	42	38	34	30	26	22	18	10
CKm 90	CK 90	0.75	1		51	49	45	41	37	33	29	25	21	13

Q = FLOW RATE H = TOTAL DYNAMIC HEAD IN METERS

Curve tolerance according to ISO 2548.

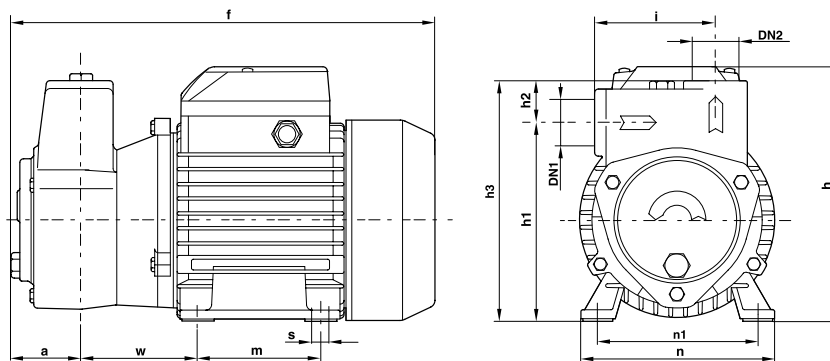

DIMENSIONS

PUMP MODEL		DN1	DN2	DIMENSIONS mm											
Single phase	Three phase			a	f	h	h1	h2	h3	i	m	n	n1	w	s
CKm 50	CK 50	3/4"	3/4"	41	260	159	128	25	153	75	80	120	100	69	7
CKm 50-BP	CK 50-BP	3/4"	3/4"	45	262	159	128	25	153	75	80	120	100	69	7
CKm 80	CK 80	1"	1"	45	291	179	136	31	167	85	90	134	112	77	7
CKm 90	CK 90	1"	1"	45	291	179	136	31	167	85	90	134	112	77	7