

Km1

asynchronous single phase electric motors

These motors are designed and manufactured with the most advanced technologies using the best materials to obtain a superior product as for sturdiness, reliability and efficiency. The possibility of using them continuously in heavy conditions, makes them suitable for professional, industrial, agricultural and do-it-yourself purposes.

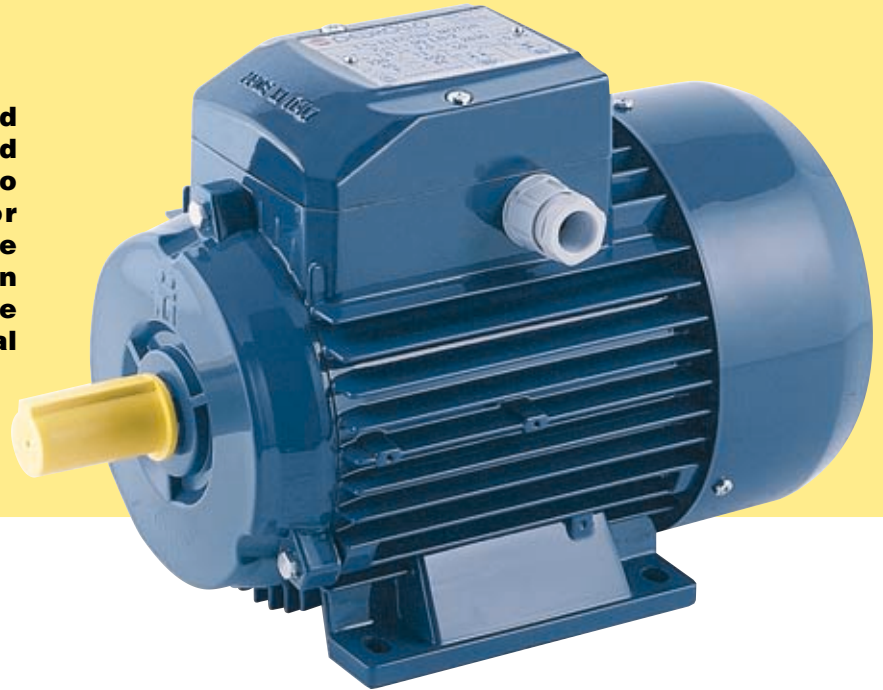

POWER RATINGS 50 Hz

0.25 ÷ 3 kW (0.33 ÷ 4 HP) 2 POLES
0.18 ÷ 2.2 kW (0.25 ÷ 3 HP) 4 POLES

OPERATING LIMITS

± 5% rated voltage
Maximum ambient temperature +40 °C
Installation altitude up to 1000 meters above sea level

CONSTRUCTION AND SAFETY STANDARDS:

EN 60 335-1
IEC 335-1
CEI 61-150

EN 60034-1
IEC 34-1
CEI 2-3



STRUCTURAL CHARACTERISTICS

Km 1 asynchronous single-phase **PEDROLLO** electric motors are closed motors with external ventilation and permanent capacitors. Motors are manufactured according to CEI EN 60034-1 (2-3 - booklet 1110) standards.

- **MOTOR:** induction closed with external ventilation (ICH1 method according to IEC 34-6 and CEI 2-7) with IMB3 - IMB5 - IMB14 structural shape, designed for continuous duty.
- The motor casing is made of die-cast aluminium with top mounted terminal box.
- The stator pack is made of low-leakage magnetic laminations (2.6 ÷ 3 Watt/kg.).
- Stator windings are manufactured automatically using wire with double class H insulation; heads are carefully bound and shaped by pressure. Impregnation is by a continuous "PREHEATING - IMMERSION - BAKING" cycle, with polyester resin, class F. This gives a high quality winding with excellent insulation and filling, plus improved head transmission to the outside.
- Insulation class B for H63 and H71 motors, class F for H80 - H90 - H100 motors.
- **MOTOR CASING:** aluminium.
- **SHIELDS:** Die-cast aluminium (with cast iron insert on MEC 100).
- **FAN:** glass-reinforced thermoplastic.
- **MOTOR SHAFT:** dynamically balanced with life-lubricated bearings.
- **TERMINAL BOX:** with PG 11 cable gland for H63-H71-H80 motors, PG 16 for H90-H100 motors.
- **CAPACITOR:** VDE-approved high performance permanent .
- **PROTECTION** IP 44 according to IEC 34-5 (on request IP55).
- **BALANCE** according to N quality grade, IEC 34-14 standard.
- **VOLTAGE:** motors are available from stock for single-phase 230Volt power supplies. Motors are designed to accept maximum ± 5% mains voltage variations with respect to rated values.
- **FREQUENCY:** motors are available from stock for 50 Hz frequencies.

WARRANTY: 2 YEARS (according to our general sales conditions).

SPECIAL FEATURES ON REQUEST:

- ⇒ other voltages are available on request
- ⇒ motors for 60 Hz frequencies are available on request

MOTOR TYPE	NOMINAL POWER		RPM	NOMINAL CURRENT	CAPACITOR	POWER FACTOR	EFFICIENCY	STARTING TORQUE	STARTING CURRENT	J
	kW	HP						NOMINAL TORQUE	NOMINAL CURRENT	

2 POLES - 230 V - 50 Hz

Km1 - 63 A/2	0.25	0.33	2730	1.8	10	0.93	65	0.70	2.9	0.0025
Km1 - 63 B/2	0.37	0.50	2730	2.75	12.5	0.90	66	0.70	3.1	0.0035
Km1 - 71 A/2	0.37	0.50	2800	3.0	10	0.83	65	0.72	3.4	0.0045
Km1 - 71 B/2	0.55	0.75	2800	4.2	20	0.86	66	0.70	3.0	0.0053
Km1 - 71 C/2	0.75	1	2800	5.2	25	0.93	68	0.71	3.2	0.0058
Km1 - 80 A/2	0.75	1	2800	5.6	31.5	0.90	72	0.75	3.3	0.0095
Km1 - 80 B/2	1.1	1.5	2800	7.5	35	0.90	72	0.77	3.3	0.012
Km1 - 80 C/2	1.5	2	2800	9.7	45	0.93	72	0.70	3.5	0.014
Km1 - 90 S/2	1.5	2	2850	9.6	45	0.93	74	0.72	3.6	0.013
Km1 - 90 LA/2	1.8	2.5	2860	13.0	45	0.83	74	0.75	3.5	0.023
Km1 - 90 LB/2	2.2	3	2840	16.0	50	0.83	74	0.70	3.6	0.026
Km1 - 100 LA/2	2.2	3	2870	14.5	55	0.87	76	0.75	3.6	0.055
Km1 - 100 LB/2	3	4	2870	18.5	60	0.80	79	0.70	4.2	0.069

4 POLES - 230 V - 50 Hz

Km1 - 71 A/4	0.25	0.33	1380	2.2	10	0.87	57	0.75	2.5	0.0005
Km1 - 71 B/4	0.37	0.50	1380	3.1	14	0.91	57	0.75	2.6	0.0073
Km1 - 80 A/4	0.55	0.75	1400	4.5	20	0.93	62	0.78	2.6	0.0022
Km1 - 80 B/4	0.75	1	1400	5.5	25	0.95	62	0.73	2.7	0.0028
Km1 - 90 S/4	1.1	1.5	1420	7.8	31.5	0.98	62	0.72	2.6	0.0037
Km1 - 90 LA/4	1.5	2	1420	10.8	40	0.95	64	0.75	2.8	0.0049
Km1 - 90 LB/4	1.8	2.5	1430	12.5	45	0.95	66	0.65	2.7	0.0053
Km1 - 100 LB/4	2.2	3	1430	14	55	0.95	72	0.60	2.6	0.0055

B3 IM 1001

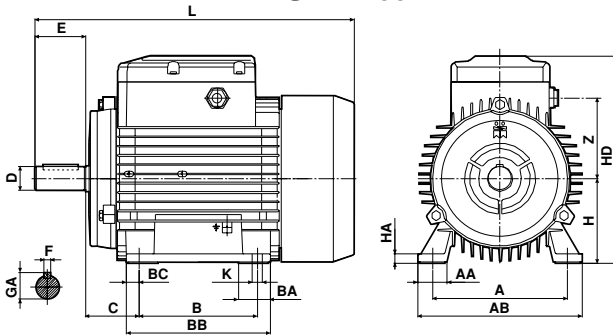

B5 IM 3001

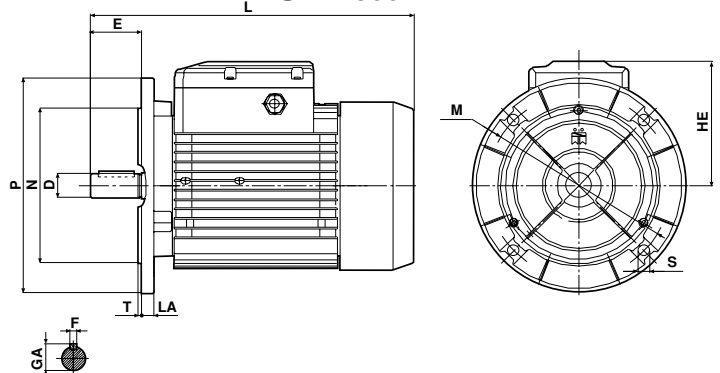

B14 IM 3601

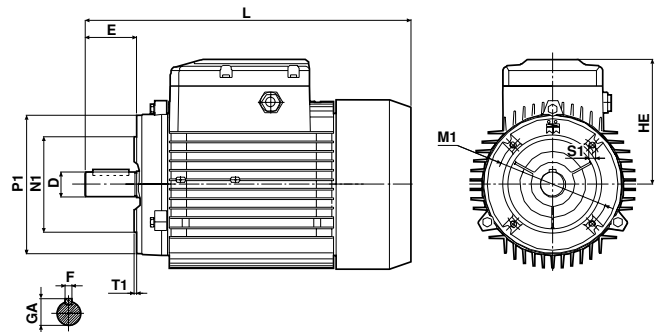

Comitato Elettrotecnico Italiano
Authorization n° prot. 1064 / 27.3.87

MOTOR TYPE	DIMENSIONS mm																																	
	2 Poles		4 Poles		A	AA	AB	AD	B	BA	BB	BC	C	D	E	F	GA	H	HA	HD	HE	K	L	LA	M	M1	N	N1	P	P1	S	S1	T	T1
Km1 - 63 A/2	-	-	100	22	120	119	80	23.5	98	9	40	11	23	4	12.5	63	8	152	91	7	209	9	115	75	95	60	140	90	9	M5	3	2.5	49.5	
Km1 - 63 B/2	-	-	100	22	120	119	80	23.5	98	9	40	11	23	4	12.5	63	8	152	91	7	209	9	115	75	95	60	140	90	9	M5	3	2.5	49.5	
Km1 - 71 A/2	Km1 - 71 A/4	-	112	23	134	141	90	24.5	110	10	45	14	30	5	16	71	8	162.5	91.5	7	243	9	130	85	110	70	160	105	9.5	M6	3.5	2.5	61	
Km1 - 71 B/2	Km1 - 71 B/4	-	112	23	134	141	90	24.5	110	10	45	14	30	5	16	71	8	162.5	91.5	7	243	9	130	85	110	70	160	105	9.5	M6	3.5	2.5	61	
Km1 - 71 C/2	-	-	112	23	134	141	90	24.5	110	10	45	14	30	5	16	71	8	162.5	91.5	7	243	9	130	85	110	70	160	105	9.5	M6	3.5	2.5	61	
Km1 - 80 A/2	Km1 - 80 A/4	-	125	27.5	152	161	100	32	124	12	50	19	40	6	21.5	80	10	202.5	122.5	9	279	10.5	165	100	130	80	200	120	11.5	M6	3.5	3	69	
Km1 - 80 B/2	Km1 - 80 B/4	-	125	27.5	152	161	100	32	124	12	50	19	40	6	21.5	80	10	202.5	122.5	9	279	10.5	165	100	130	80	200	120	11.5	M6	3.5	3	69	
Km1 - 80 C/2	-	-	125	27.5	152	161	100	32	124	12	50	19	40	6	21.5	80	10	202.5	122.5	9	299	10.5	165	100	130	80	200	120	11.5	M6	3.5	3	69	
Km1 - 90 S/2	Km1 - 90 S/4	-	140	30	170	176	100	32.5	125	12.5	56	24	50	8	27	90	10	218.5	128.5	9	297	10	165	115	130	95	200	140	11.5	M8	3.5	3	75	
Km1 - 90 LA/2	Km1 - 90 LA/4	-	140	30	170	176	125	32.5	150	12.5	56	24	50	8	27	90	10	218.5	128.5	9	322	10	165	115	130	95	200	140	11.5	M8	3.5	3	75	
Km1 - 90 LB/2	Km1 - 90 LB/4	-	140	30	170	176	125	32.5	150	12.5	56	24	50	8	27	90	10	218.5	128.5	9	322	10	165	115	130	95	200	140	11.5	M8	3.5	3	75	
Km1 - 100 LA/2	-	-	160	34	194	197	140	37	170	15	63	28	60	8	31	100	11	245	145	12	368	14	215	130	180	110	250	160	14	M8	4	3.5	95	
Km1 - 100 LB/2	Km1 - 100 LB/4	-	160	34	194	197	140	37	170	15	63	28	60	8	31	100	11	245	145	12	368	14	215	130	180	110	250	160	14	M8	4	3.5	95	