



**side suction peripheral pumps**  
(for industrial uses)



**PQm 60**



**PERFORMANCE RANGE**

Flow rate up to 90 l/min (5.4 m<sup>3</sup>/h)  
Dynamic head up to 180 m

**OPERATING LIMITS**

Suction lift up to 8 m  
Fluid temperature up to + 60°C  
Maximum ambient temperature + 40°C

**CONSTRUCTION AND SAFETY STANDARDS:**

EN 60 335-1	EN 60034-1
IEC 335-1	IEC 34-1
CEI 61-150	CEI 2-3

**PUMP INSTALLATION AND APPLICATIONS**

These pumps are suitable for pumping clean water not containing abrasive particles and fluids which are not chemically aggressive to the pump components.

**THE HYDRAULIC PERFORMANCE OF THESE STURDY AND COMPACT PUMPS ALSO MAKES THEM IDEALLY SUITED FOR INDUSTRIAL APPLICATIONS, SINCE THEY CAN BE INSTALLED IN CONDITIONS PROHIBITIVE FOR OTHER PUMP TYPES.**

These pumps should be installed in a covered area, protected against weather.

**WARRANTY: 2 YEARS**

(according to our general sales conditions).

**STRUCTURAL CHARACTERISTICS**

- **PUMP BODY:** cast iron, with UNI ISO 228/1 gas threaded suction and delivery openings.
- **MOTOR BRACKET** patented n° 1289150: aluminium with front brass insert; reducing difficulties when starting the pump after long periods without use, due to the impeller blocking.
- **IMPELLER:** brass.
- **MOTOR SHAFT:** AISI 430F stainless steel (AISI 416 up to 0.50 kW).
- **MECHANICAL SEAL:** ceramic and graphite.
- **MOTOR:** the pumps are coupled to an asynchronous, high efficiency PEDROLLO induction motor of suitable size, which is quiet, closed and externally ventilated, with an «IM B3» structural shape, suitable for continuous duty. INSULATION class F (B up to 0.75 kW) (PQ3000 class H).  
The thermal cutout relay (motor protector) is incorporated in single phase motors.  
Three phase motors require an adequate external motor protector, with connections according to current standards.
- **PROTECTION:** IP 44 (PQ 3000 IP 55).
- **REGISTERED MODEL** n° 72753.

**SPECIAL FEATURES ON REQUEST:**

- ⇒ AISI 316 stainless steel motor shaft
- ⇒ EPDM, VITON (or other on request) mechanical seal
- ⇒ IP 55 protection
- ⇒ insulation class F
- ⇒ other voltages
- ⇒ 60 Hz frequency
- ⇒ for higher temperature pumped liquids
- ⇒ for use in areas with a higher temperature



## PERFORMANCE CHART AT n= 2900 1/min

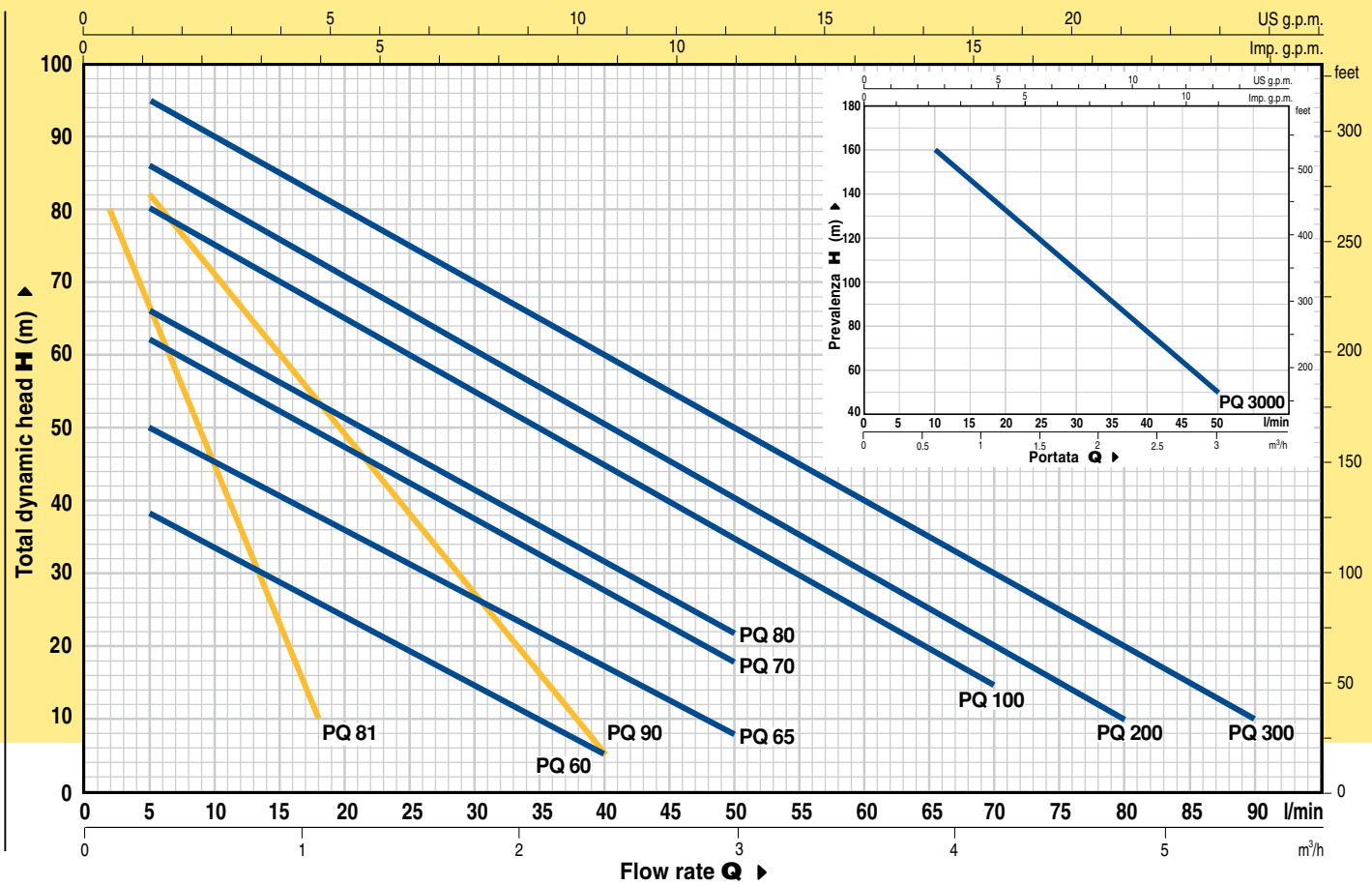

## PERFORMANCE DATA AT n= 2900 1/min

PUMP MODEL		POWER		Q m³/h	H (m)															
Single phase	Three phase	kW	HP		0	0.3	0.6	0.9	1.2	1.5	1.8	2.1	2.4	3.0	3.6	4.2	4.8	5.4		
				l/min	0	5	10	15	20	25	30	35	40	50	60	70	80	90		
PQm 60	PQ 60	0.37	0.50	H (m)	40	38	33.5	29	24	19.5	15	10	5							
PQm 65	PQ 65	0.50	0.70		55	50	45.5	40.5	36	31	27	22	17	8						
PQm 70	PQ 70	0.60	0.85		65	62	57	52	47	42	37	32	27	18						
PQm 80	PQ 80	0.75	1		70	66	61	56	51	46	41	36.5	31	22						
PQm 90	PQ 90	0.75	1		90	82	71	60	49	38	27	17	5							
PQm 100	PQ 100	1.1	1.5		85	80	75	70	65	60	55	50	45	35	25	15				
PQm 200	PQ 200	1.5	2		90	86	81	76	71	65.5	60	55	50	40	30	20	10			
---	PQ 300	2.2	3		100	95	90	85	80	75	70	65	60	50	40	30	20	10		
---	PQ 3000	2.2	3		180	170	160	145	132	118	105	92	78	50						

PUMP MODEL		POWER		Q m³/h	H (m)									
Single phase	Three phase	kW	HP		0	0.12	0.24	0.36	0.48	0.60	0.72	0.84	0.96	1.08
				l/min	0	2	4	6	8	10	12	14	16	18
PQm 81	PQ 81	0.50	0.70	H (m)	90	80	71	63	54	45	37	28	19	10

Q = FLOW RATE H = TOTAL DYNAMIC HEAD IN METERS

Curve tolerance according to ISO 2548.

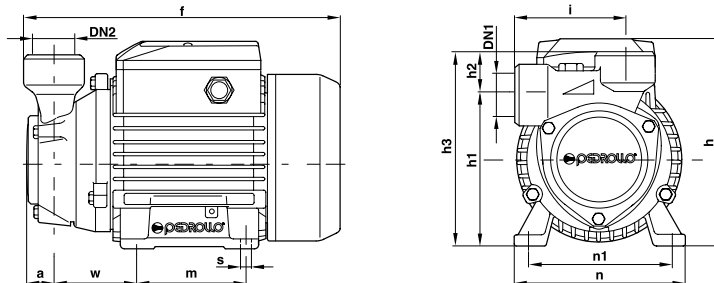

## DIMENSIONS

PUMP MODEL		DIMENSIONS mm													
Single phase	Three phase	DN1	DN2	a	f	h	h1	h2	h3	i	m	n	n1	w	s
PQm 60	PQ 60	1"	1"	22	223	152	108	30	138	78	80	120	100	55	7
PQm 65	---	1"	1"	22	234	152	113	30	143	78	80	120	100	57	7
---	PQ 65	1"	1"	22	227	152	113	30	143	78	80	120	100	57	7
PQm 70, 80	PQ 70, 80	1"	1"	22	253	179	121	30	151	83	90	138	112	62	7
PQm 81	---	1/2"	1/2"	18	227	152	118	23	141	71	80	120	100	58	7
---	PQ 81	1/2"	1/2"	18	220	152	118	23	141	71	80	120	100	58	7
PQm 90	PQ 90	3/4"	3/4"	22	253	179	126	27	153	84	90	138	112	62	7
PQm 100	PQ 100	1"	1"	25	292	203	140	30	170	89	100	158	125	85	9
PQm 200	---	1"	1"	25	312	203	140	30	170	89	100	158	125	85	9
---	PQ 200	1"	1"	25	292	203	140	30	170	89	100	158	125	85	9
---	PQ 300	1"	1"	25	312	203	140	30	170	89	100	158	125	85	9
---	PQ 3000	3/4"	3/4"	34	323	203	142	38	180	65	100	158	125	97	9